

Signature
Awning Window
Gas Strut (100mm)

Installation Details

BRICK VENEER CONSTRUCTION - SILL & JAMB DETAIL
GAS STRUT - STANDARD.

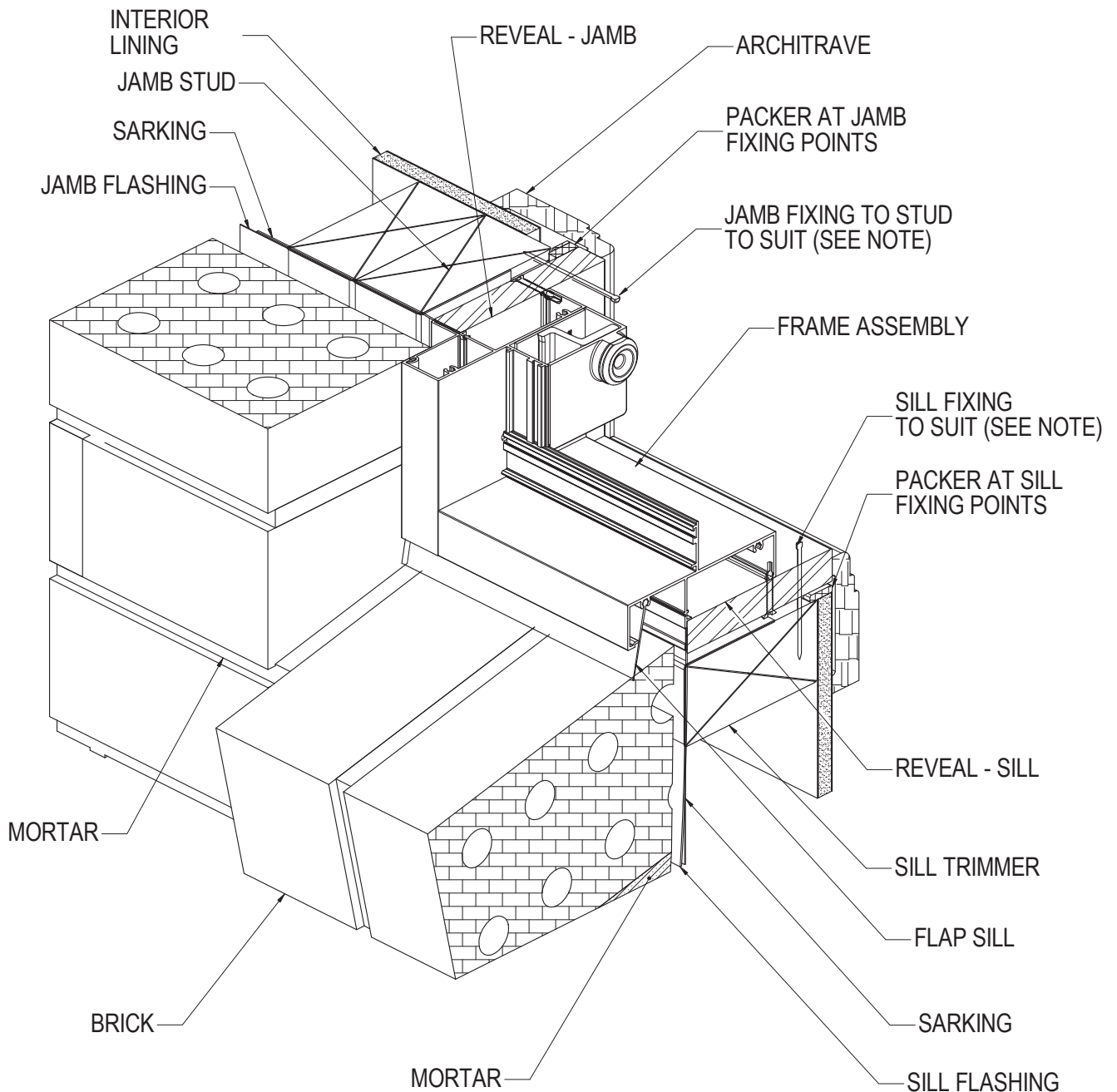

INSTRUCTION:
FOR SITE CLASSIFICATIONS OF UP TO AND INCLUDING 'N6' OR SIMILAR, FIXINGS ARE TO BE AT 450mm CENTRE MAXIMUM, FOR SITUATIONS IN EXCESS OF THIS THE FIXINGS ARE TO BE AT 300mm CENTRES MAXIMUM. FIXING SIZE TO BE EQUIVALENT TO A ϕ 2.2mm STEEL NAIL MINIMUM. NO PACKERS AT HEAD FIXINGS.

REFER SIG-AWN- 02-16,09-13 & 02-15-2 FOR ADDITIONAL DETAILS.

PRODUCT NO: SIG 100 AWN - GAS STRUT

DATE: 29/09/21

DRAWING NO: SIG-AWN-02-15-1

ISSUE: A

DRAWN: GS

SCALE: 1 : 3

BRICK VENEER CONSTRUCTION - SILL & JAMB DETAIL
GAS STRUT - SERVERY

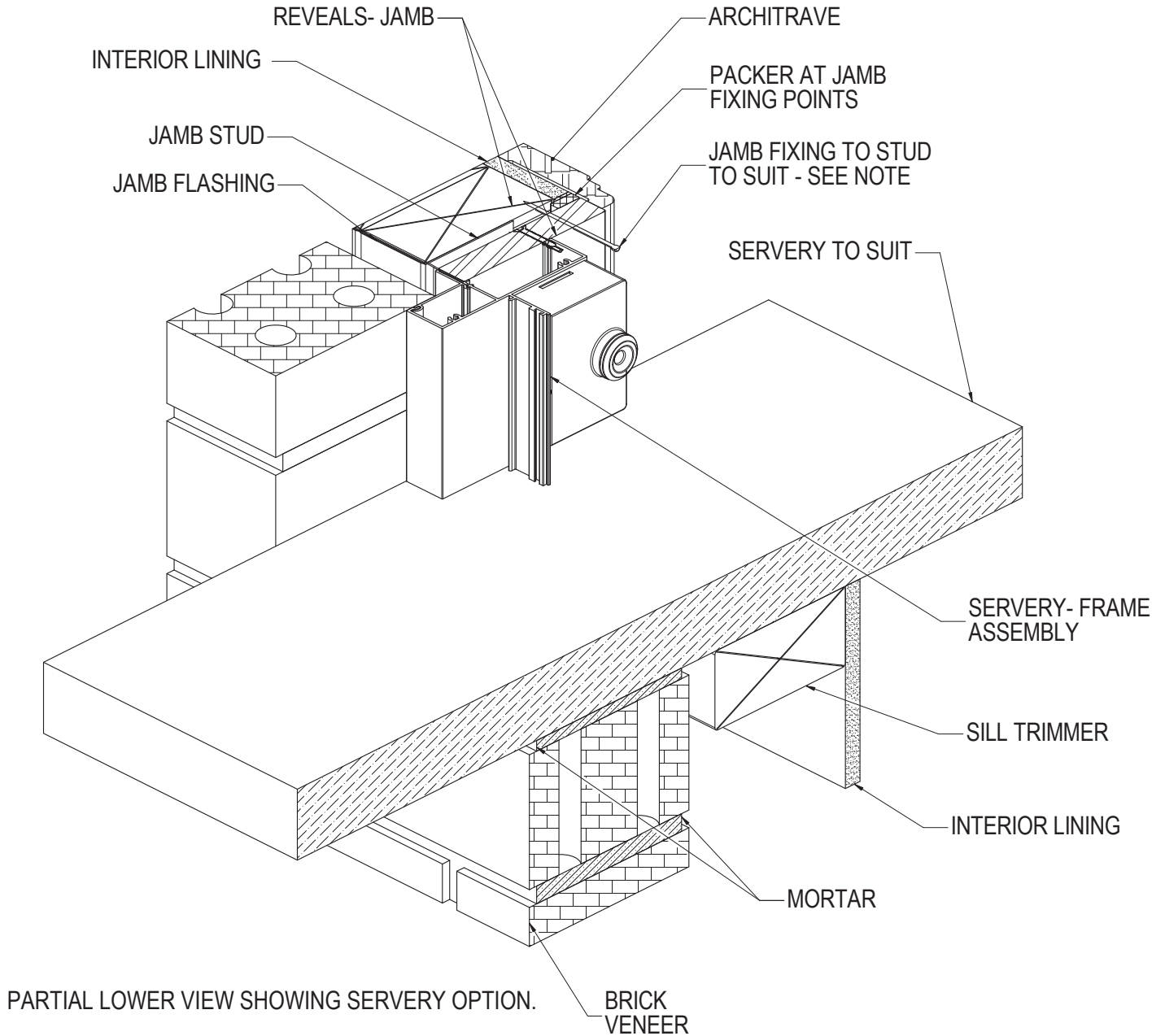

INSTRUCTION:
FOR SITE CLASSIFICATIONS OF UP TO AND INCLUDING 'N6' OR SIMILAR, FIXINGS ARE TO BE AT 450mm CENTRE MAXIMUM, FOR SITUATIONS IN EXCESS OF THIS THE FIXINGS ARE TO BE AT 300mm CENTRES MAXIMUM. FIXING SIZE TO BE EQUIVALENT TO A ϕ 2.2mm STEEL NAIL MINIMUM. NO PACKERS AT HEAD FIXINGS

REFER SIG-AWN-02-15-1, 09-13 AND 02-16 FOR JAMB AND HEAD FIXING.

PRODUCT NO: SIG-AWN-100

DATE: 29/09/21

DRAWING NO: SIG-AWN-02-15-2

ISSUE: A

DRAWN: GS

SCALE: 1 : 3

BRICK VENEER CONSTRUCTION - HEAD & JAMB DETAIL
GAS STRUT - STANDARD & SERVERY

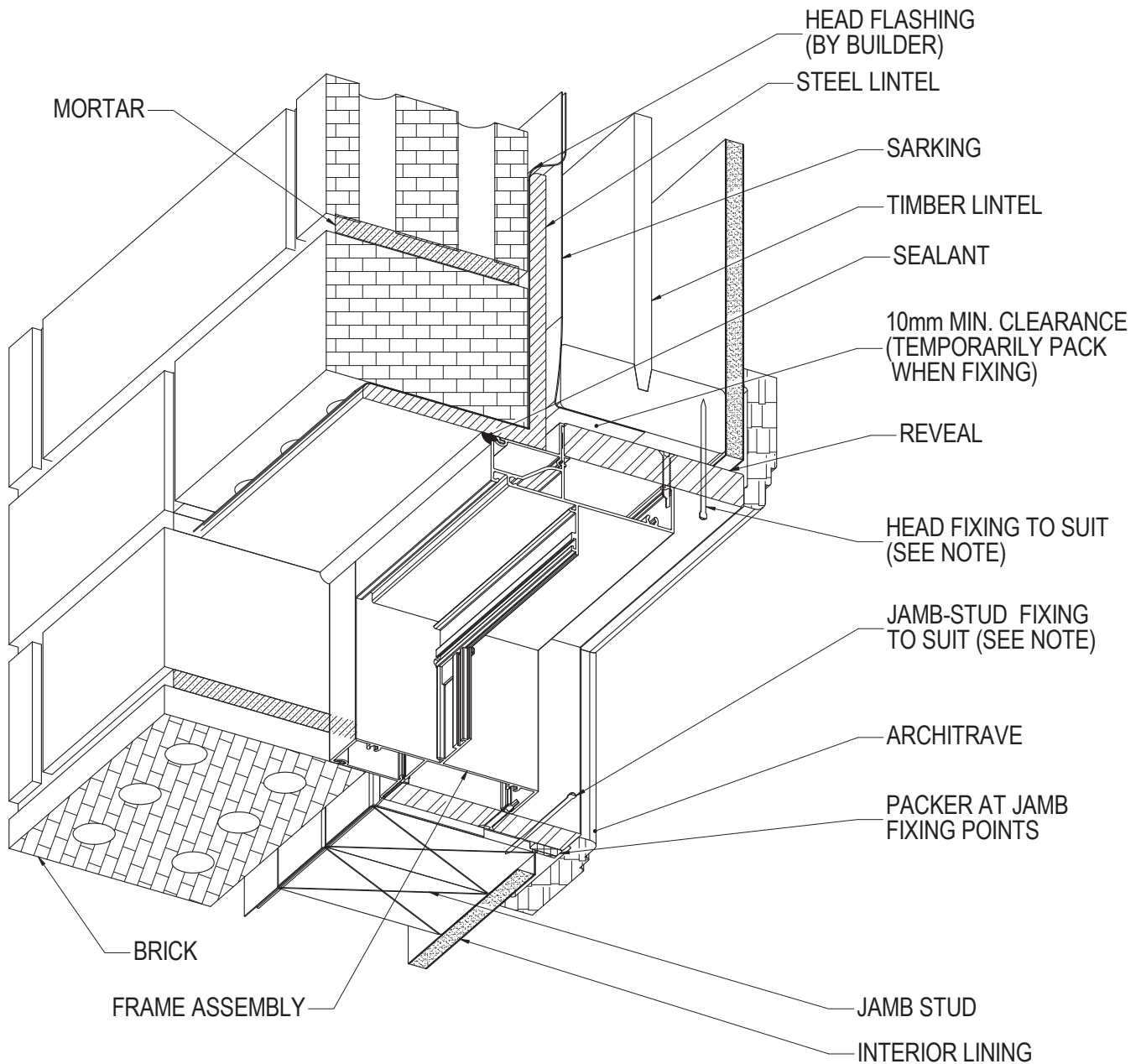

INSTRUCTION:
FOR SITE CLASSIFICATIONS OF UP TO AND INCLUDING 'N6' OR SIMILAR, FIXINGS ARE TO BE AT 450mm CENTRE MAXIMUM, FOR SITUATIONS IN EXCESS OF THIS THE FIXINGS ARE TO BE AT 300mm CENTRES MAXIMUM. FIXING SIZE TO BE EQUIVALENT TO A \varnothing 2.2mm STEEL NAIL MINIMUM. NO PACKERS AT HEAD FIXINGS.

REFER SIG-AWN- 02-15-1, 09-13 & 02-15-2 (SERVERY) FOR ADDITIONAL DETAILS.

PRODUCT NO: SIG 100 AWN - GAS STRUT

DATE: 29/09/21

DRAWING NO: SIG-AWN-02-16

ISSUE: A

DRAWN: GS

SCALE: 1 : 3



CLADDING CONSTRUCTION - SILL & JAMB DETAIL
GAS STRUT - STANDARD.

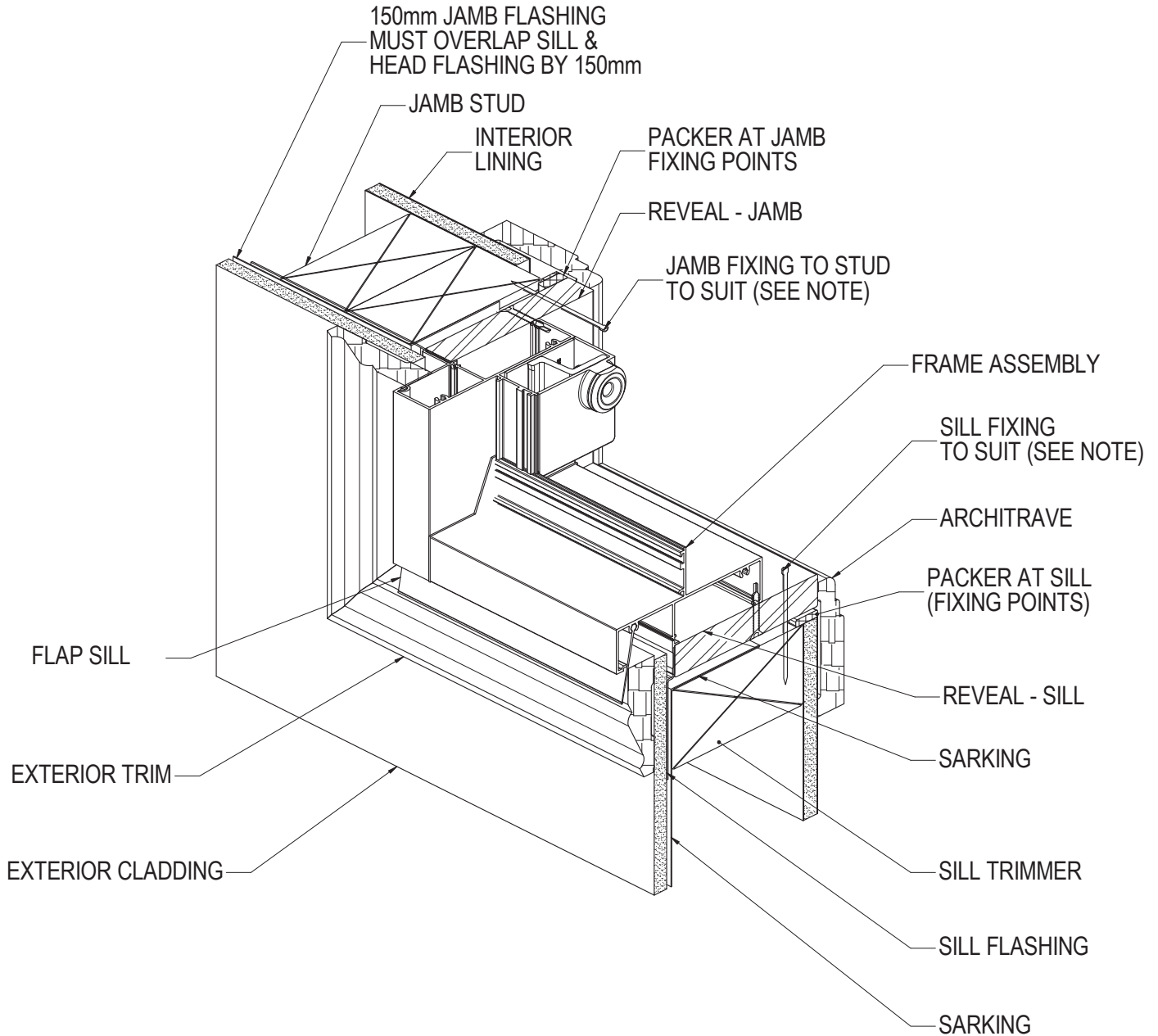

INSTRUCTION:
FOR SITE CLASSIFICATIONS OF UP TO AND INCLUDING 'N6' OR SIMILAR, FIXINGS ARE TO BE AT 450mm CENTRE MAXIMUM, FOR SITUATIONS IN EXCESS OF THIS THE FIXINGS ARE TO BE AT 300mm CENTRES MAXIMUM. FIXING SIZE TO BE EQUIVALENT TO A ϕ 2.2mm STEEL NAIL MINIMUM. NO PACKERS AT HEAD FIXINGS

REFER SIG-AWN- 02-18, 09-13 & 02-17-2 (SERVERY) FOR ADDITIONAL DETAILS.

PRODUCT NO: SIG 100 AWN - GAS STRUT

DATE: 29/09/21

DRAWING NO: SIG-AWN-02-17-1

ISSUE: A

DRAWN: GS

SCALE: 1 : 3



CLADDING CONSTRUCTION - SILL & JAMB DETAIL
GAS STRUT - STANDARD & SERVERY.

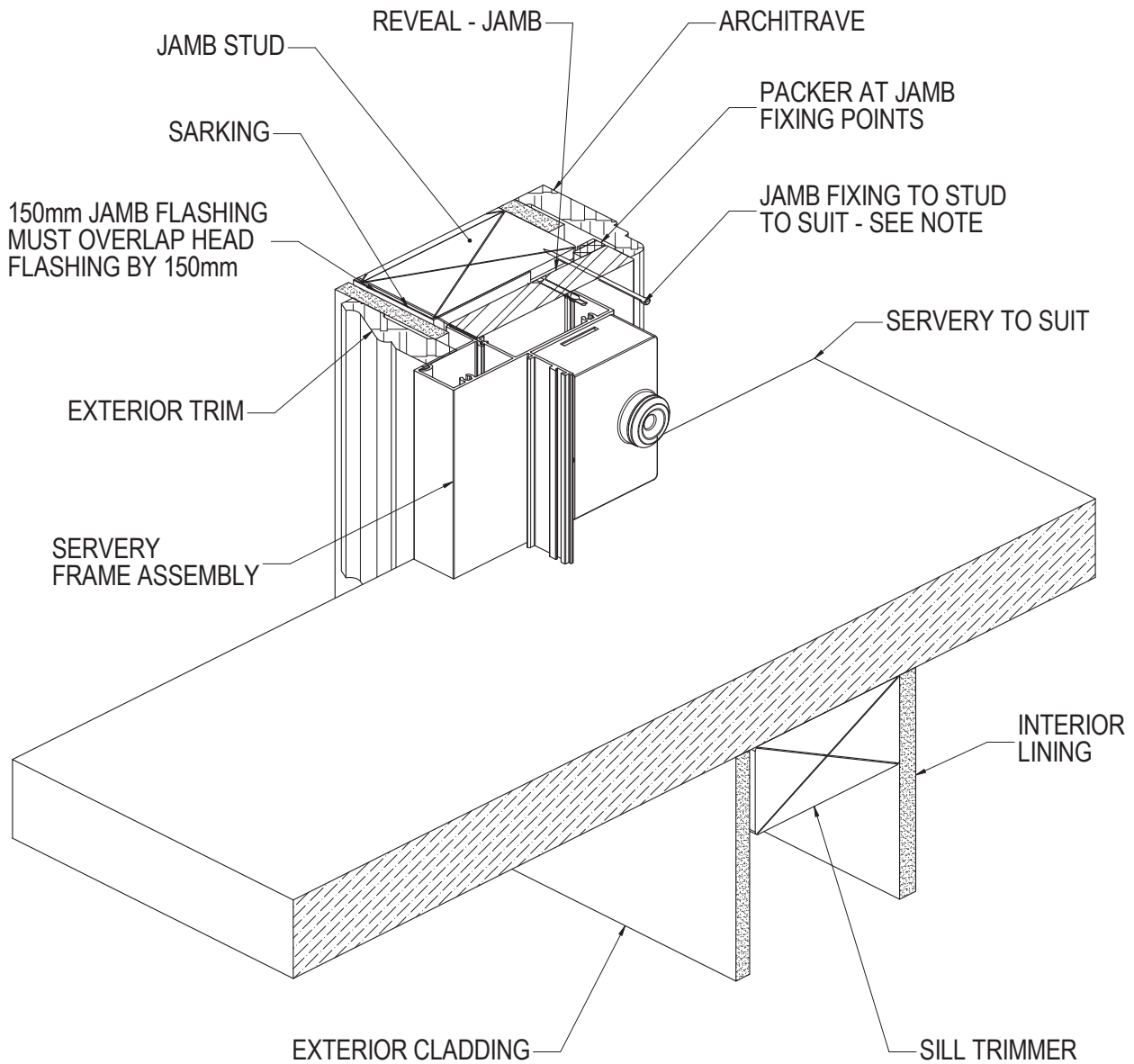

PARTIAL LOWER VIEW SHOWING SERVERY OPTION.

INSTRUCTION:

FOR SITE CLASSIFICATIONS OF UP TO AND INCLUDING 'N6' OR SIMILAR, FIXINGS ARE TO BE AT 450mm CENTRE MAXIMUM, FOR SITUATIONS IN EXCESS OF THIS THE FIXINGS ARE TO BE AT 300mm CENTRES MAXIMUM. FIXING SIZE TO BE EQUIVALENT TO A ϕ 2.2mm STEEL NAIL MINIMUM.

NO PACKERS AT HEAD FIXINGS

REFER SIG-AWN- 02-18, 02-17-1 & 09-13 FOR ADDITIONAL DETAILS.

PRODUCT NO: SIG 100 AWN - GAS STRUT

DATE: 29/09/21

DRAWING NO: SIG-AWN-02-17-2

ISSUE: A

DRAWN: GS

SCALE: 1 : 3



CLADDING CONSTRUCTION - HEAD & JAMB DETAIL
GAS STRUT - STANDARD & SERVERY.

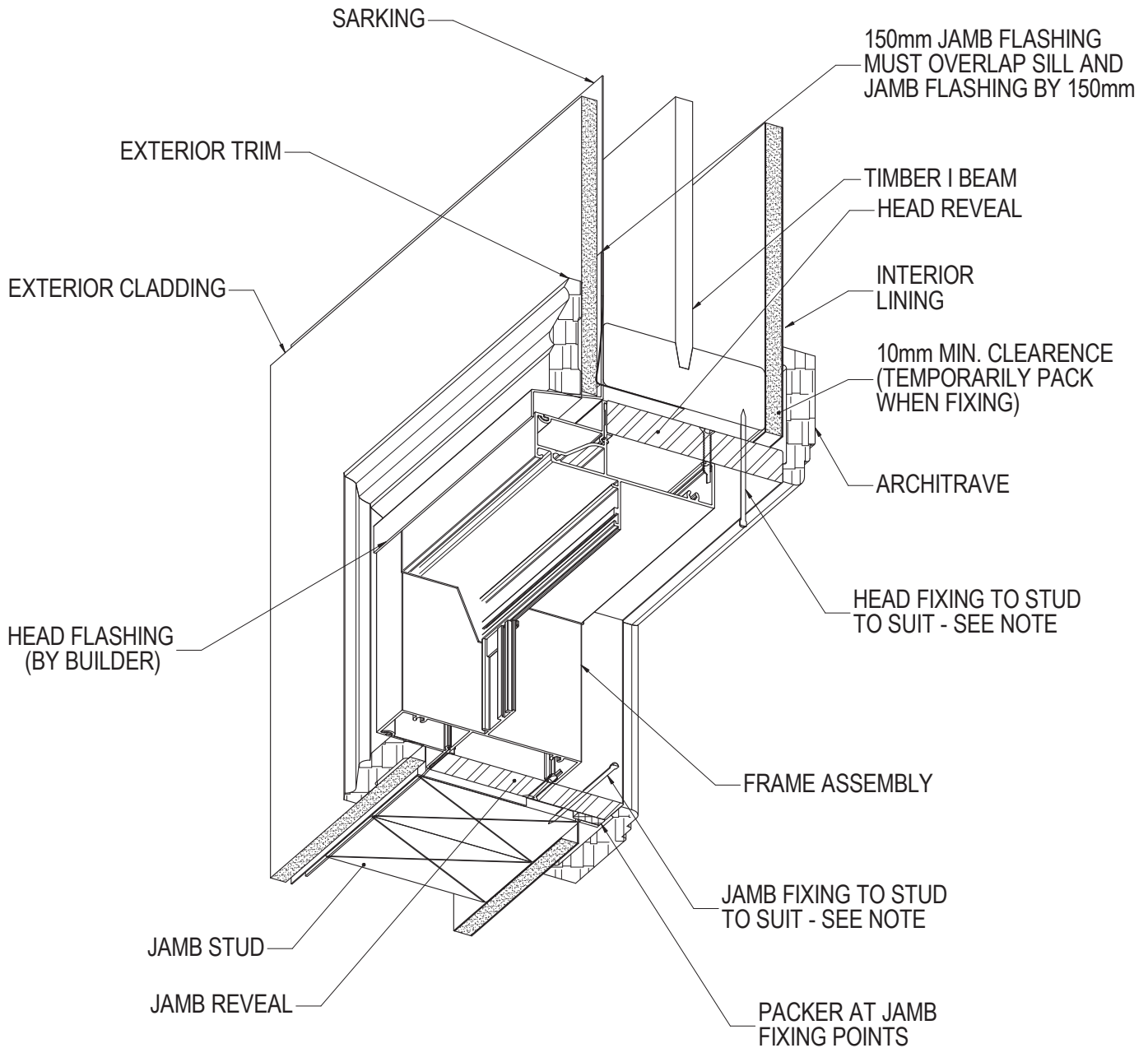

INSTRUCTION:
FOR SITE CLASSIFICATIONS OF UP TO AND INCLUDING 'N6' OR SIMILAR, FIXINGS ARE TO BE AT 450mm CENTRE MAXIMUM, FOR SITUATIONS IN EXCESS OF THIS THE FIXINGS ARE TO BE AT 300mm CENTRES MAXIMUM. FIXING SIZE TO BE EQUIVALENT TO A ϕ 2.2mm STEEL NAIL MINIMUM. NO PACKERS AT HEAD FIXINGS

REFER SIG-AWN- 02-17-1, 02-17-2 (SERVERY) & 09-13 FOR ADDITIONAL DETAILS.

PRODUCT NO: SIG 100 AWN - GAS STRUT	DATE: 29/09/21
DRAWING NO: SIG-AWN-02-18	ISSUE: A
DRAWN: GS	SCALE: 1 : 3



CAVITY BRICK CONSTRUCTION - SILL & JAMB DETAIL
GAS STRUT - STANDARD.

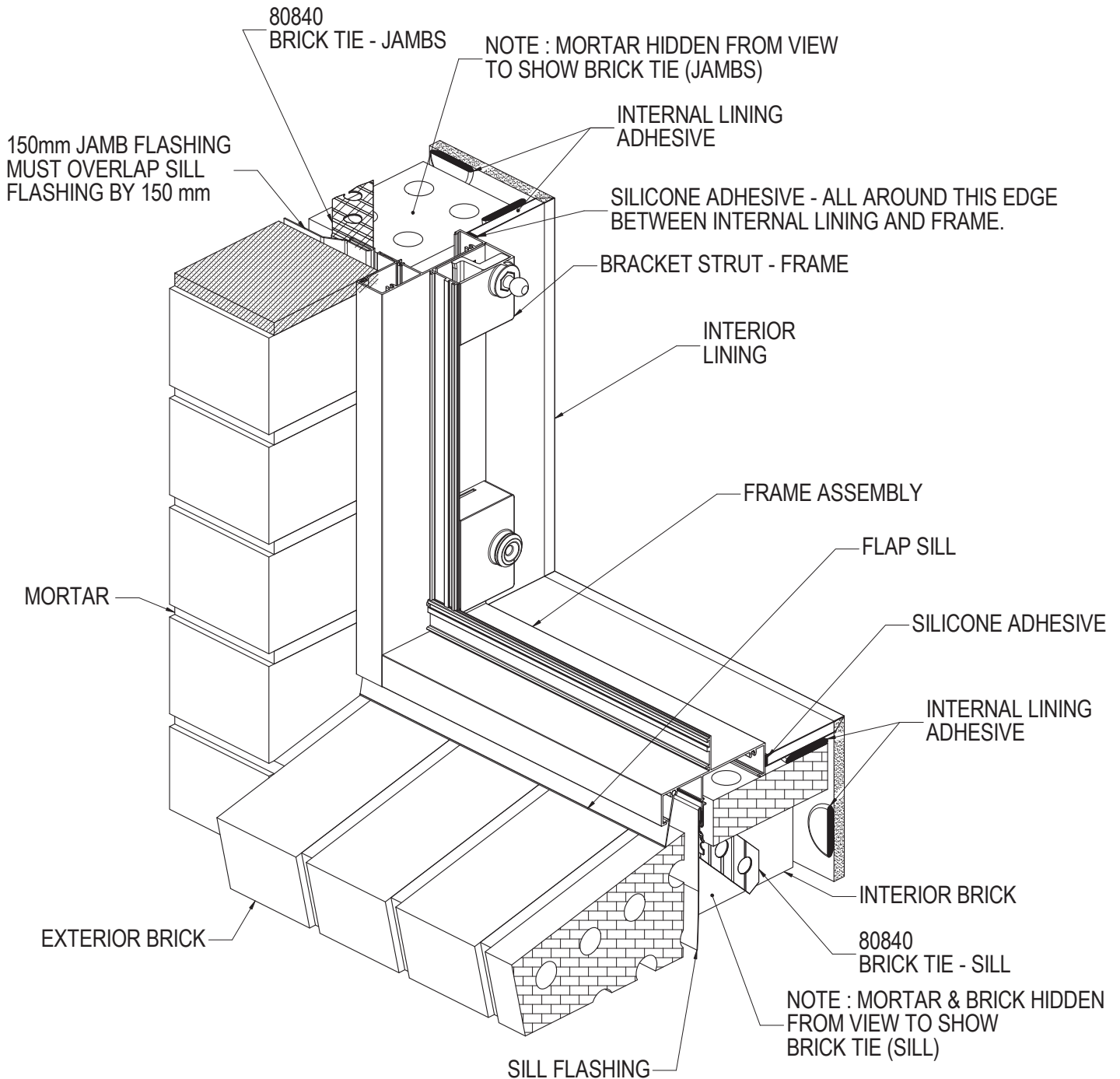

NOTE:
REFER SIG-AWN- 02-20 FOR ADDITIONAL DETAILS.

PRODUCT NO: SIG 100 AWN - GAS STRUT

DRAWING NO: SIG-AWN-02-19-1

DRAWN: GS

DATE: 29/09/21

ISSUE: A

SCALE: 1 : 3

CAVITY BRICK CONSTRUCTION - SILL & JAMB DETAIL
GAS STRUT - SERVERY.

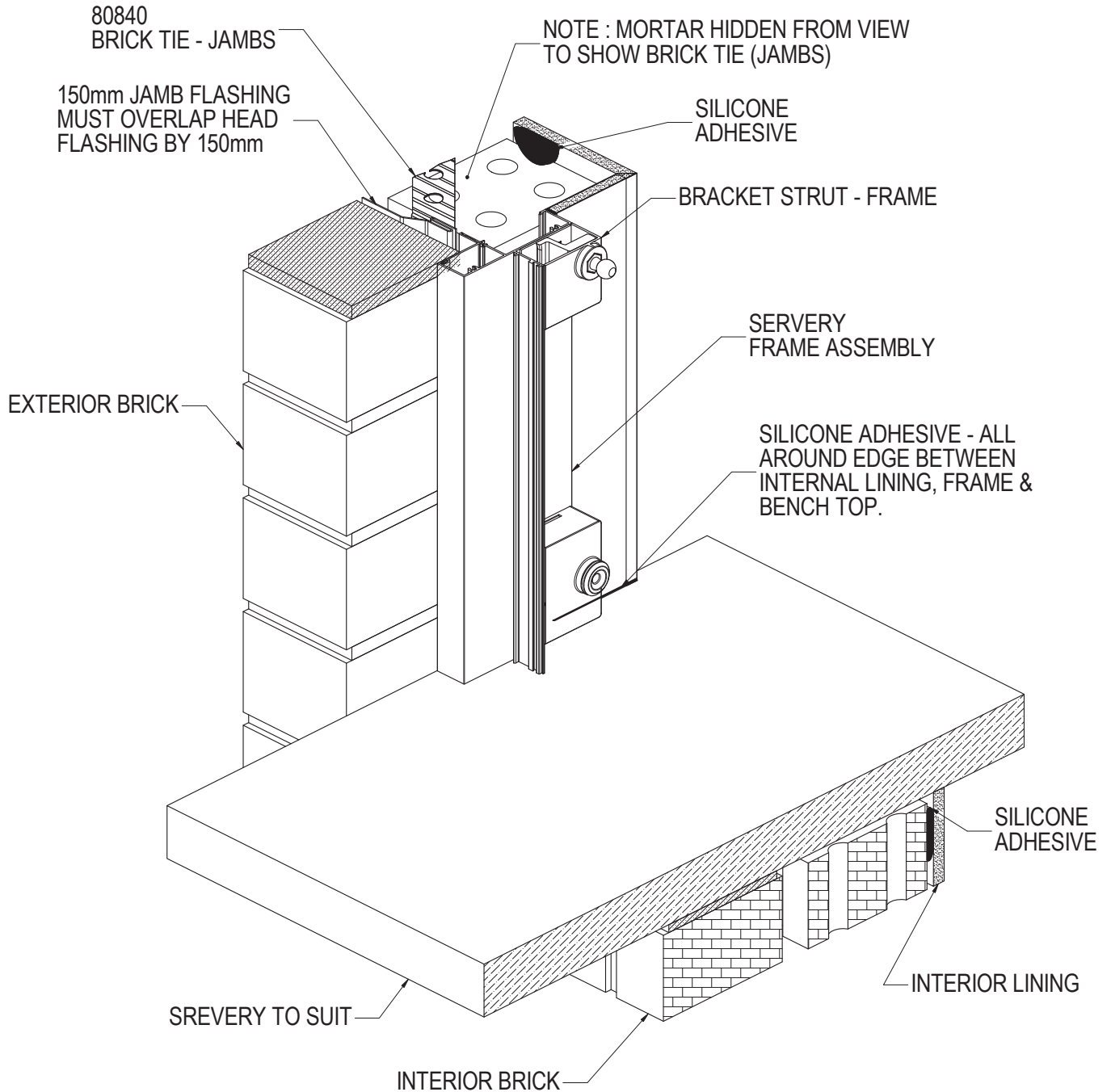

NOTE:
REFER SIG-AWN- 02- 20 FOR ADDITIONAL DETAILS.

PRODUCT NO: SIG 100 AWN - GAS STRUT

DATE: 29/09/21

DRAWING NO: SIG-AWN-02-19-2

ISSUE: A

DRAWN: GS

SCALE: 1 : 3

CAVITY BRICK CONSTRUCTION - HEAD & JAMB DETAIL
GAS STRUT - STANDARD & SERVERY.

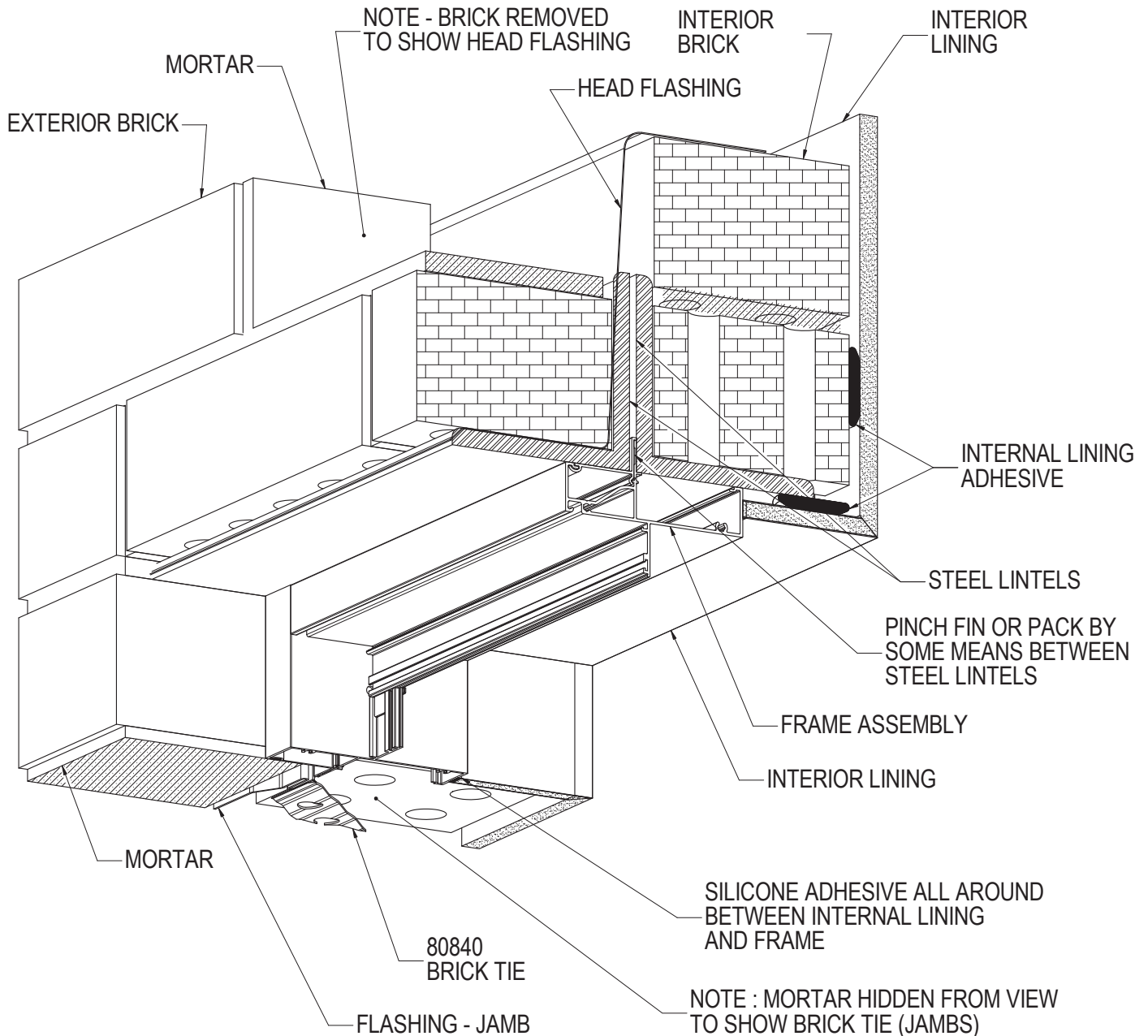

INSTRUCTION:
1ST BRICK TIE-JAMB TO BE POSITIONED AS CLOSE AS POSSIBLE TO BRACKET STRUT - FRAME, 2ND BRICK TIE - JAMB TO BE CLOSEST TO THE HEAD AND THEN ON APPROX 170mm APART - ALONG JAMB & SILL FOR STANDARD & JAMBS FOR SERVERY.
NO HEAD FIXINGS, HOWEVER PINCH HEAD FIN BETWEEN STEEL LINTELS OR ALTERNATIVELY PACK TO ANCHOR HEAD FIN.

REFER SIG-AWN- 02-19-1 & 02-19-2 FOR ADDITIONAL DETAILS.

PRODUCT NO: SIG 100 AWN - GAS STRUT

DATE: 29/09/21

DRAWING NO: SIG-AWN-02-20

ISSUE: A

DRAWN: GS

SCALE: 1 : 3